



INSTALLATION INSTRUCTIONS

Accessory

FOG LIGHTS

Application

CIVIC
2- AND 4-DOOR
(DX, HX)

Publications No.

All 24171

Issue Date

AUG 2002

NOTE: Fog Lights cannot be installed if the vehicle is equipped with an optional Front Under Spoiler.

PARTS LIST

Fog Lights (Sold separately)
P/N 08V31-S5D-103

Left fog light



Right fog light

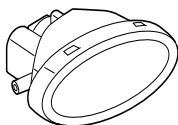

Left trim

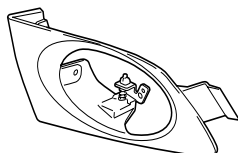

Right trim

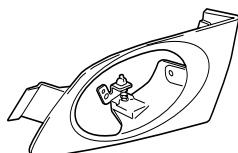

2 Stepped screws, 4 mm



4 Self-tapping screws



4 Spring nuts



2 Washer-screws, 4 x 8 mm



Switch harness

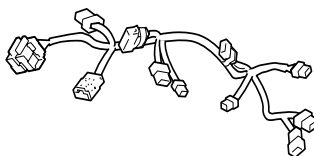

Fog light harness

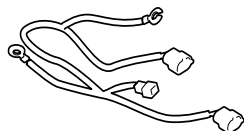

Relay

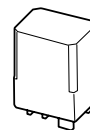

Fuse label

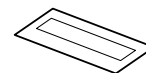

Template

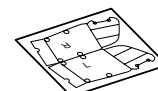

26 Wire ties

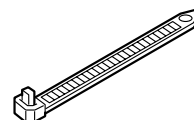

7 Wire ties with clip

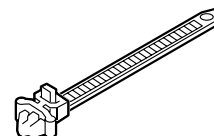

2 Ground bolts



2 Cushion tapes

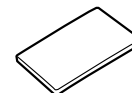

Washer-bolt, 6 x 16 mm

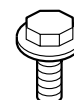

Relay bracket

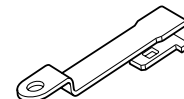

Subharness

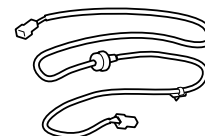

Switch Kit (Sold separately)
P/N 08V31-S5D-111G (for 4-door)
P/N 08V31-S5P-110G (for 2-door)

Switch

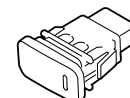

TOOLS AND SUPPLIES REQUIRED

#2 Phillips screwdriver
Flat-tip screwdriver
Ratchet
10 mm Socket
Drill
5 mm and 10 mm Drill bits
Diagonal cutters
Utility knife
Tape measure
Felt-tip pen
Gloves
Tape
Scissors
Masking tape
Hacksaw blade
Thumbtack

Illustration of the Fog Lights Installed on the Vehicle

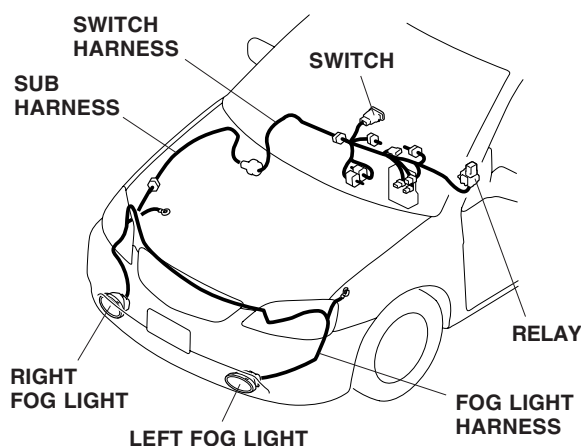

INSTALLATION

Customer Information: The information in this installation instruction is intended for use only by skilled technicians who have the proper tools, equipment, and training to correctly and safely add equipment to your car. These procedures should not be attempted by “do-it-yourselfers.”

1. Make sure you have the anti-theft code for the radio, then write down the frequencies for the preset buttons.
2. Disconnect the negative cable from the battery.

Cutting the Front Bumper

3. Locate the right and left templates included in the kit and cut them out using scissors. The templates are marked “R” and “L.”
4. Position the left template (L) on the bumper, and align it with the bumper grille. Using masking tape, attach the template to the bumper. To protect the bumper, apply masking tape to the bumper along the edges of the template.

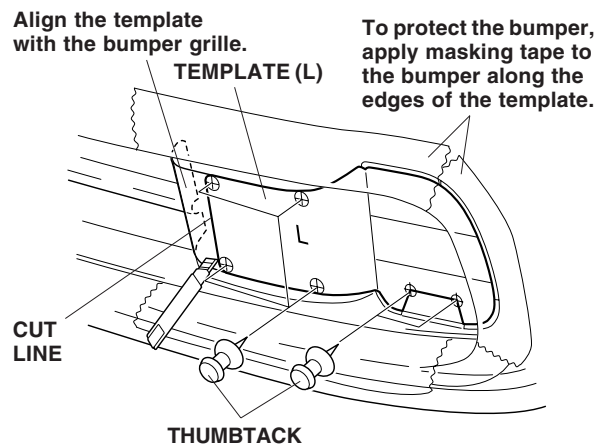

5. Using a thumbtack, mark the bumper at each of the six holes indicated on the template.
 6. While wearing gloves, use a utility knife to score the bumper along the cut line as indicated on the template.
 7. Remove the left template. While wearing eye protection, drill a 5 mm hole through each of the six marked locations. Enlarge the four center holes to 10 mm.
- To prevent damaging the vehicle parts, wrap a tape around the drill bit at a point about 15 mm from the end as shown.

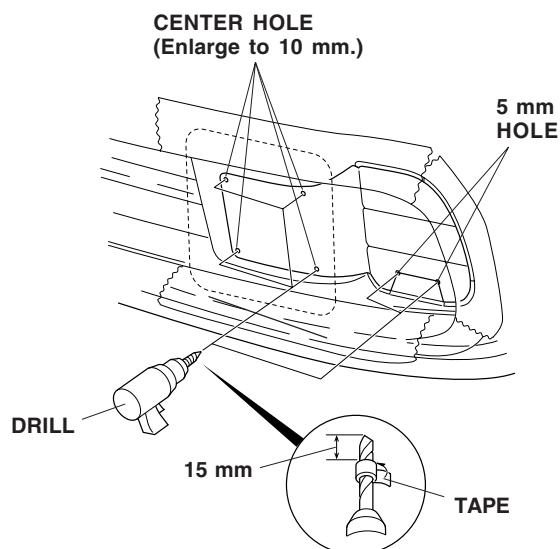

8. While wearing gloves, cut out the marked area of the bumper with a hacksaw blade. Be careful not to damage the horn harness routed inside the bumper.

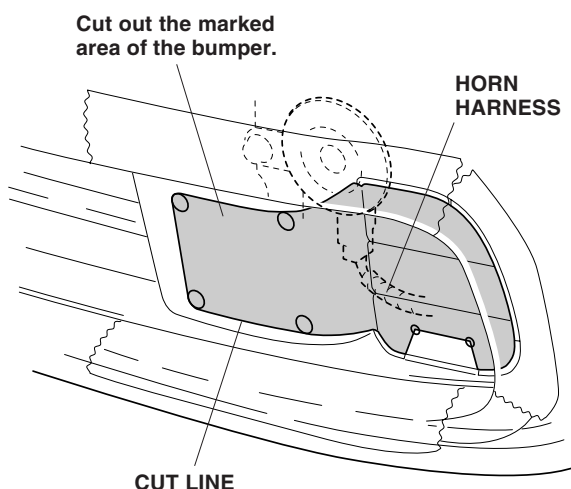

9. Remove any burrs from the edges of the hole.
10. Tape the right template to the bumper, and repeat steps 5 through 9 to cut out the right fog light opening.

Routing the Fog Light Harness

11. Remove the four clips and two self-tapping screws, and pull the right (passenger's) side front inner fender down in the direction shown.

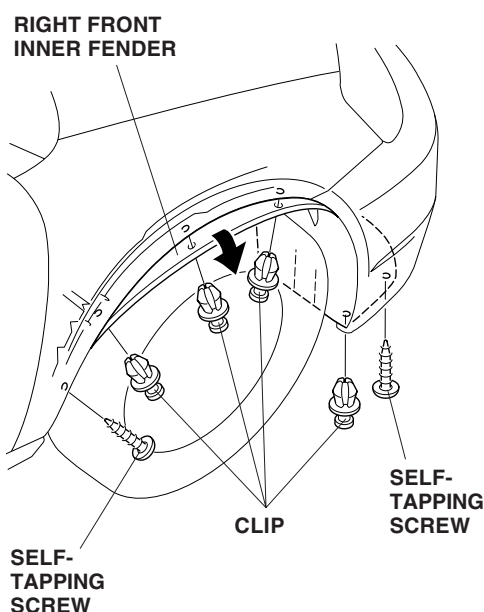

12. Route the fog light harness (the end with the 2-pin connector and the 1-pin connector) through the square hole under the right headlight into the engine compartment.

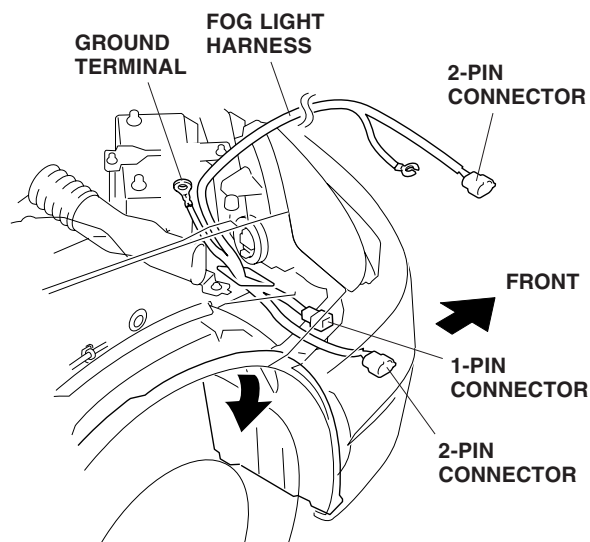

13. Behind the right headlight, remove and discard the bolt fastening the fuse box bracket. Attach the fog light harness ground terminal to the fuse box bracket with a ground bolt from the kit.

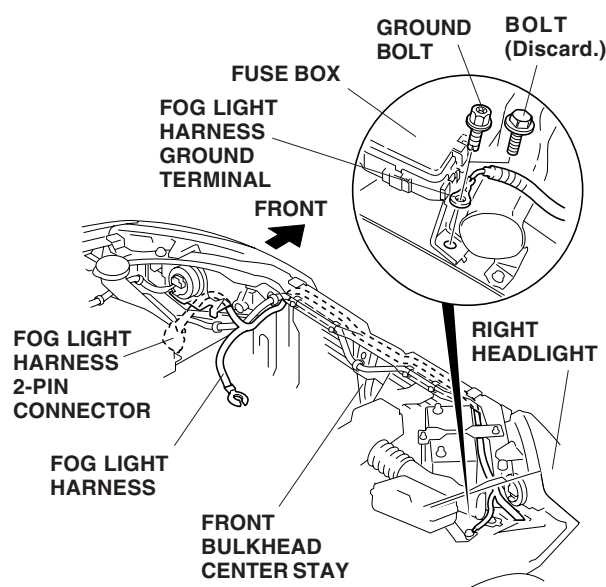

14. Route the other end of the fog light harness toward the driver's side of the vehicle along the vehicle harness, behind the front bulkhead center stay. If the vehicle is not equipped with A/C, the vehicle harness will end at the middle of the vehicle.
15. Continue routing the fog light harness 2-pin connector through the hole under the driver's side headlight and into the front bumper area.

16. Route the fog light harness ground terminal to the back of the left (driver's) side headlight.
17. Attach the fog light harness ground wire.

With ABS Unit

Remove and discard the existing ground bolt from the ABS unit bracket. Attach the fog light harness ground terminal to the ABS unit bracket using a ground bolt from the kit.

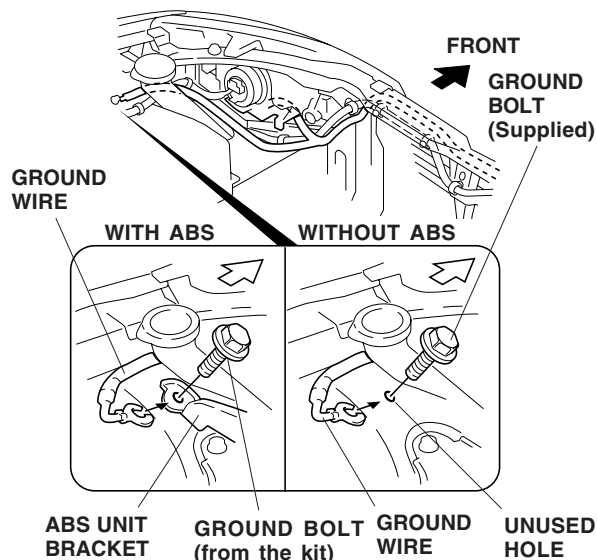

Without ABS Unit

Locate the unused threaded hole under the windshield wiper fluid filler neck. Attach the fog light harness ground wire to the unused hole using a ground bolt from the kit.

18. Secure the fog light harness.

With Air Conditioner:

Secure the fog light harness to the vehicle harness with seven wire ties, then secure the fog light harness to the side bulkhead using one wire tie with clip in the areas shown.

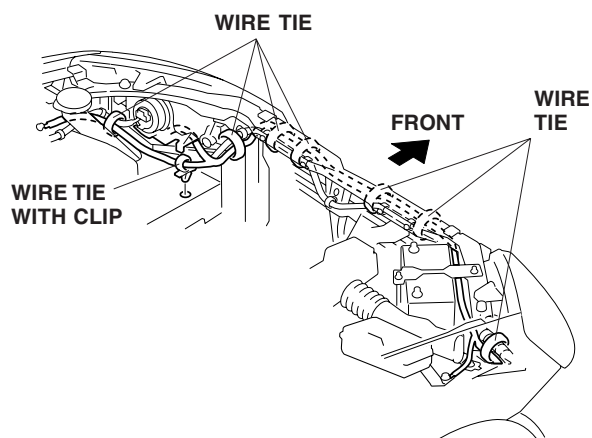

Without Air Conditioner:

Secure the fog light harness to the vehicle harness with three wire ties, then secure the fog light harness to the front and side bulkhead using four wire ties with clips in the areas shown.

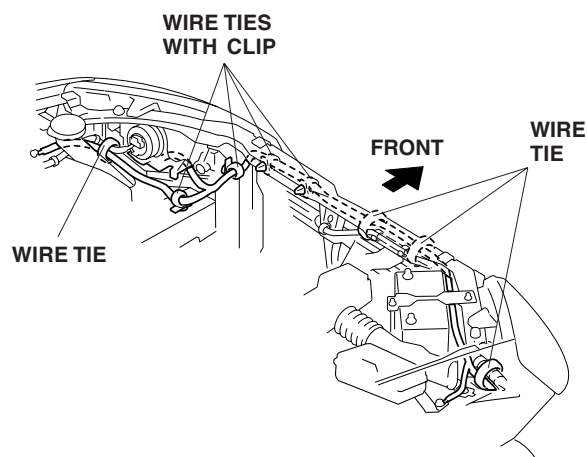

19. On the right (passenger's) side of the vehicle, secure the fog light harness to the hole in the front wheelhouse, and to the hole in the front lower cross member with one wire tie with clip at each location. Never secure the fog light harness to the yellow SRS harness.

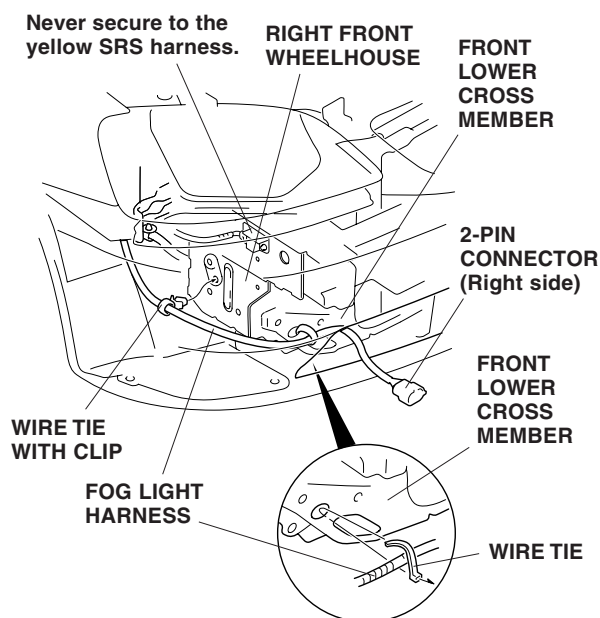

20. Remove the left (driver's) side front inner fender (three clips, one self-tapping screw and pull down in the direction shown).

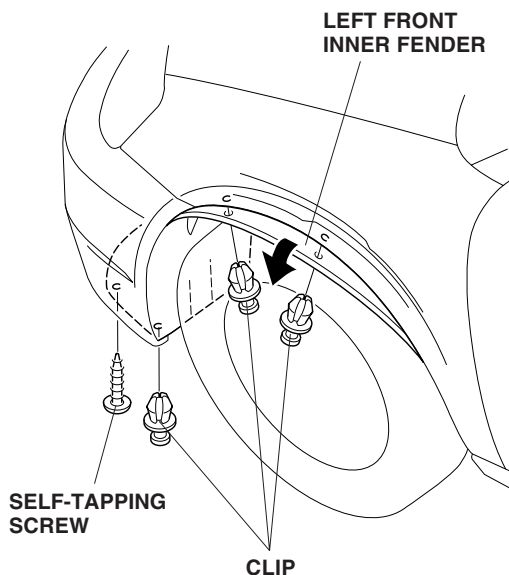

21. Inside the front bumper, secure the fog light harness on the left (driver's) side of the vehicle to the hole in the front cross member with three wire ties in the areas shown. **Never secure the fog light harness to the yellow SRS harness.**

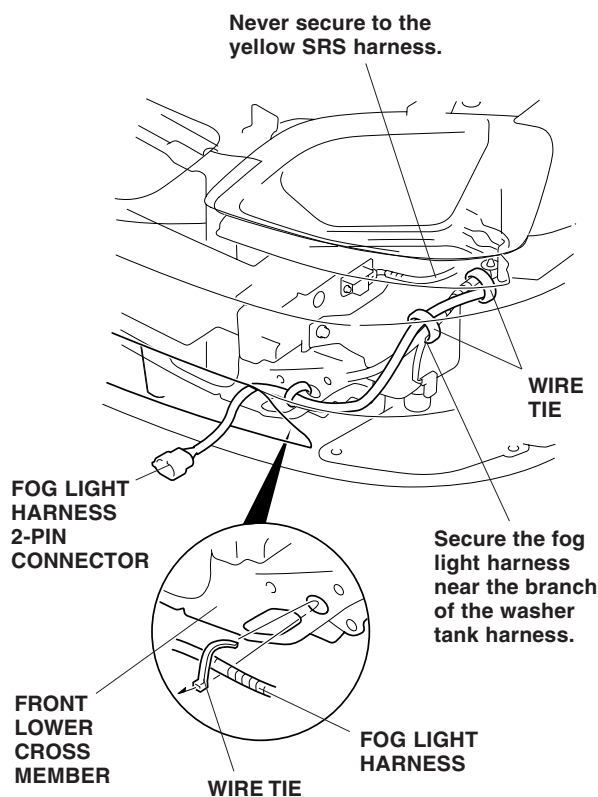

Installing the Fog Light

22. Position the left fog light on the left trim, and install one stepped screw and one washer-screw.

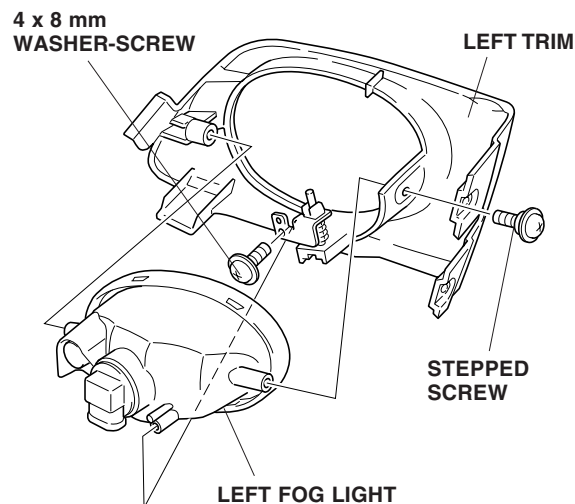

23. Slide two spring nuts onto the bumper flange, aligning the spring nuts with the guide ribs.

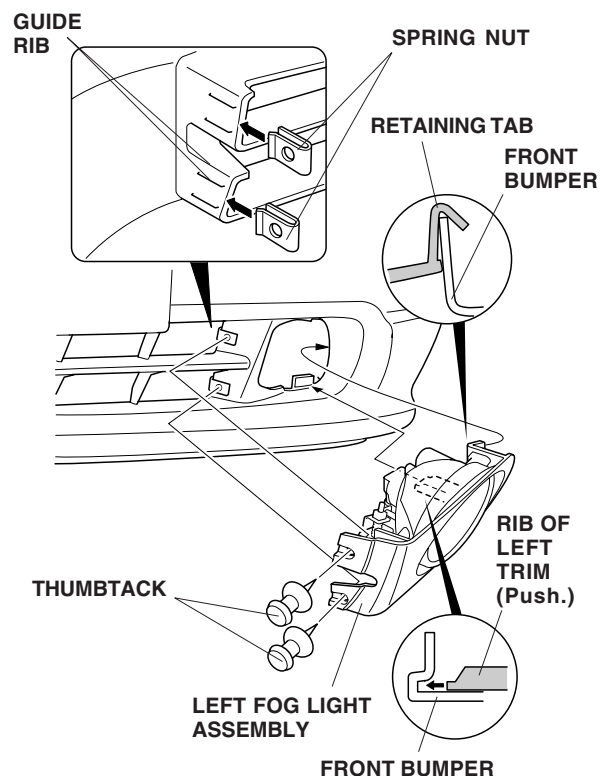

24. Fit the fog light assembly into position in the opening of the front bumper with the retaining tab behind the bumper. Using a thumbtack, mark the bumper at each of the two mounting holes, then remove the fog light assembly.

25. Pull the fog light harness 2-pin connector out through the opening in the bumper, and plug it into the left fog light.

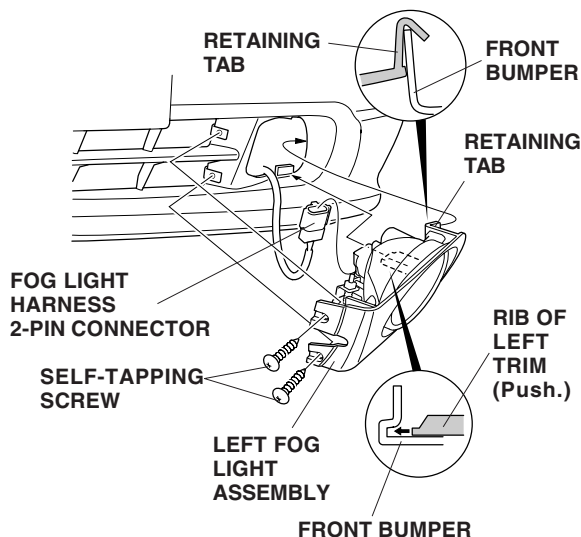

26. Reinstall the left fog light assembly in the front bumper. While holding pressure on the fog light assembly, install the two self-tapping screws to secure the fog light assembly.
27. Repeat steps 22 through 26 to install the right fog light assembly.

Routing the Subharness

28. Inside the right front inner panel, locate the rubber grommet. Push the grommet out and into the passenger's compartment. Route the male end of the subharness into the passenger's compartment, and seat the harness grommet in the panel hole.

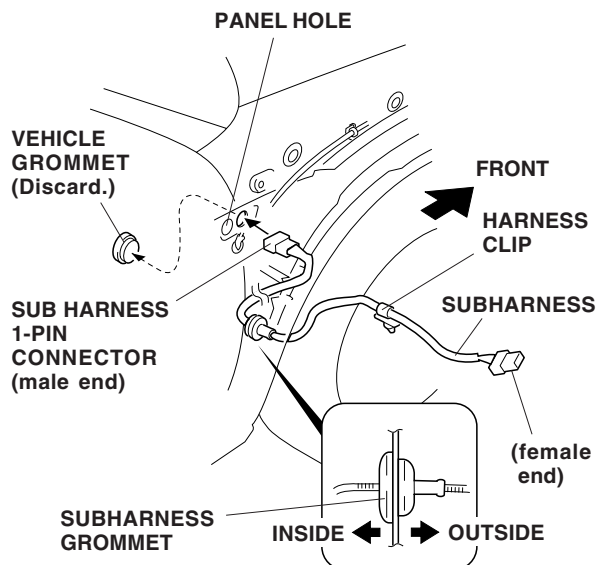

29. Route the female end of the subharness through the inner fender toward the front of the vehicle. Plug the sub harness 1-pin connector into the fog light harness 1-pin connector routed in step 12.

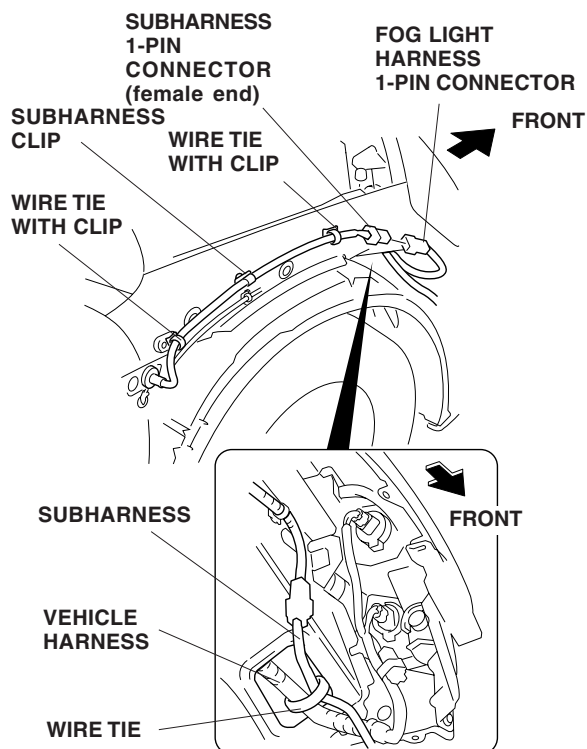

30. Secure the fog light harness to the vehicle harness with one wire tie in the area shown. Secure the subharness to the inner fender panel with two wire ties with clips from the kit, and with one wire tie with clip attached to the subharness. Insert the clips into the empty holes in the inner fender panel.

Routing the Switch Harness

31. Inside the passenger's compartment, remove the dashboard lower cover on the driver's side. Turn the two knobs counterclockwise, and release the four retaining tabs.

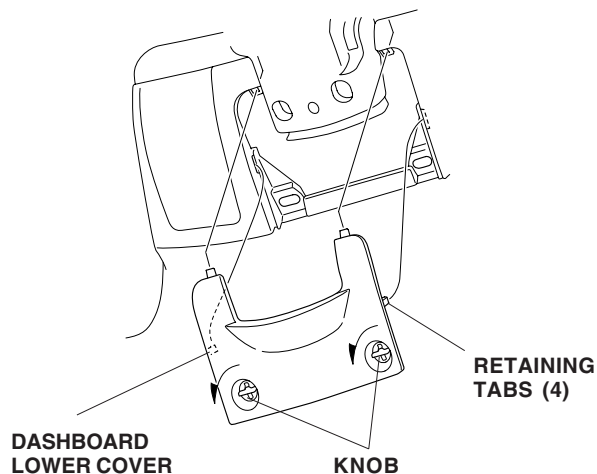

32. Remove the driver's dashboard under cover. Turn the knob counterclockwise, and release the two clips and one retaining tab.

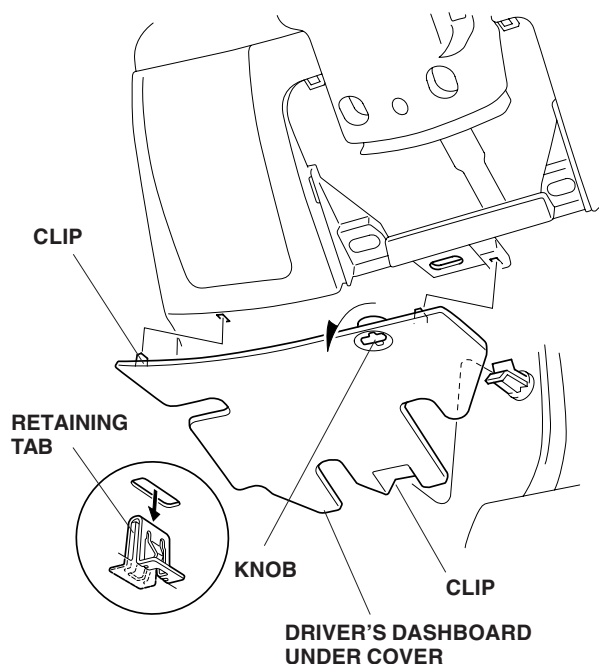

33. Remove the driver's pocket (one self-tapping screw and two retaining tabs). When the switch is equipped, open the pocket, remove the self-tapping to release the panel and disconnect the harness from the switches.

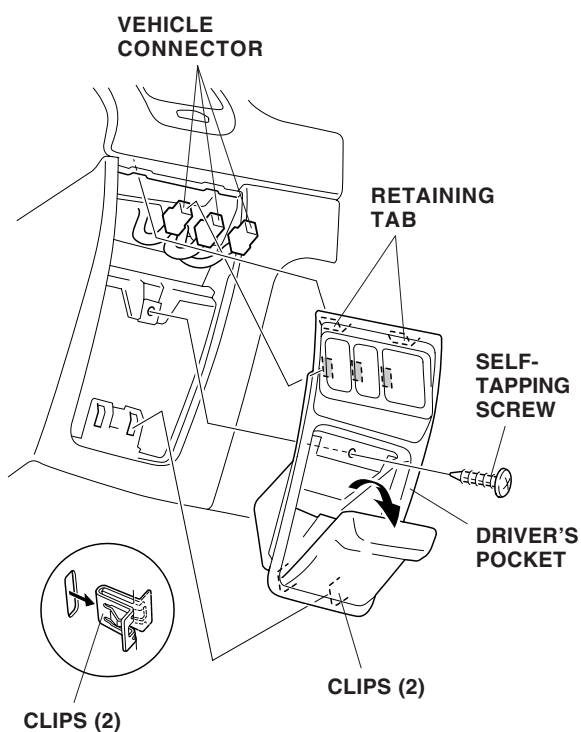

34. Remove the right (passenger's) side kick panel (two clips).

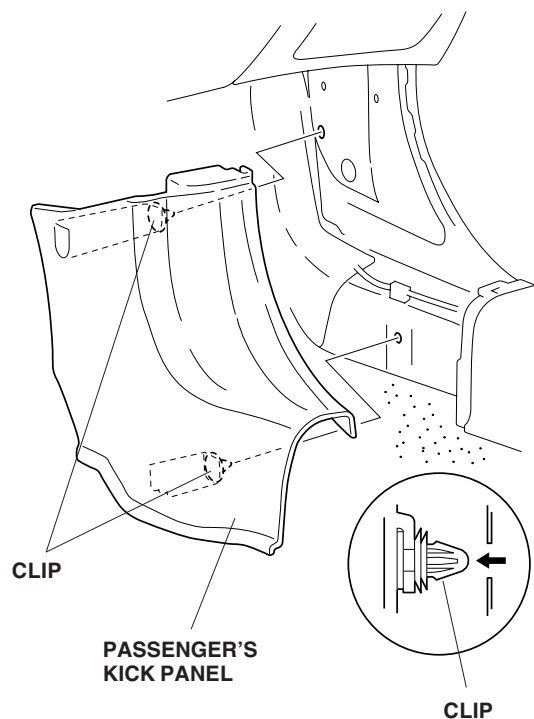

35. Remove the center console tray (nine clips).

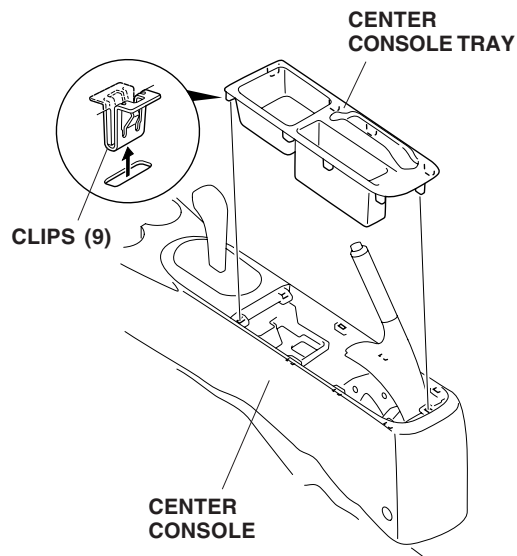

36. Remove the center console (two self-tapping screws, two washer-screws, and two clips). On the M/T model, remove the shift knob.

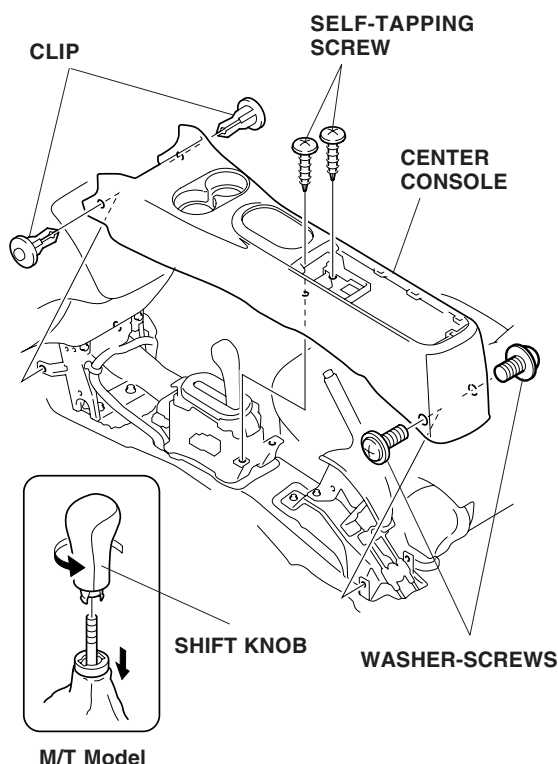

37. Remove the dashboard center lower cover.

Without a Cigarette Lighter and Ashtray:

- With the parking brake applied, place the gearshift lever in the neutral position.
- Gently pry out on the lower cover to release the six retaining clips.
- Unplug the accessory socket connector and remove the lower cover.

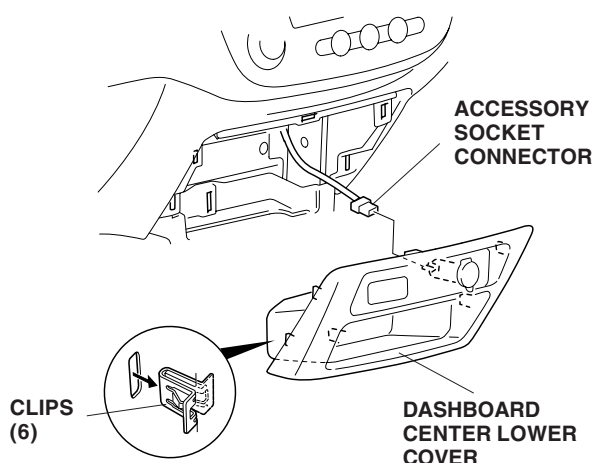

With a Cigarette Lighter and Ashtray:

- With the parking brake applied, place the gearshift lever in the Neutral position.
- Remove the ashtray.
- Inside the ashtray opening, remove the one self-tapping screw securing the dashboard center lower cover.
- Gently pry out on the lower cover to release the six retaining clips.
- Unplug the cigarette lighter connectors, and the illumination bulb, then remove the lower cover.

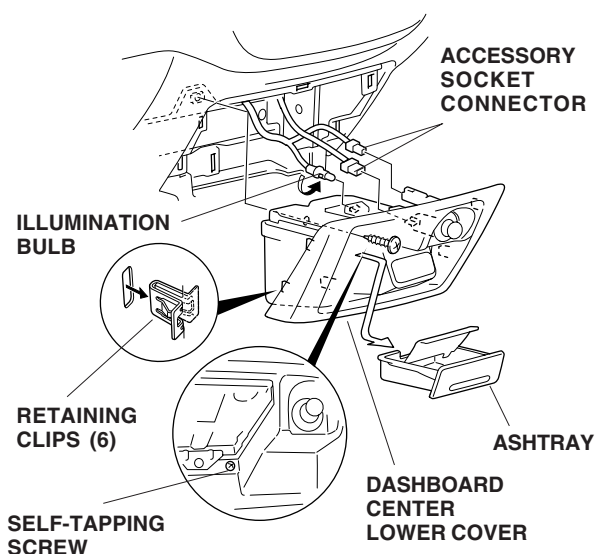

38. Lower the passenger's side under cover, release the three clips and remove the under cover.

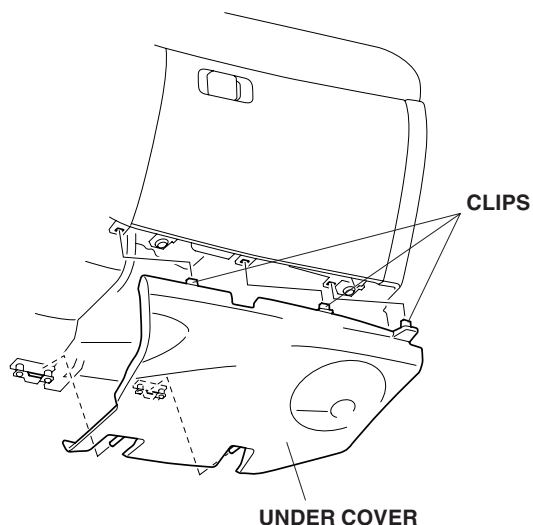

39. Open the glove box completely, and remove the stopper from each side.

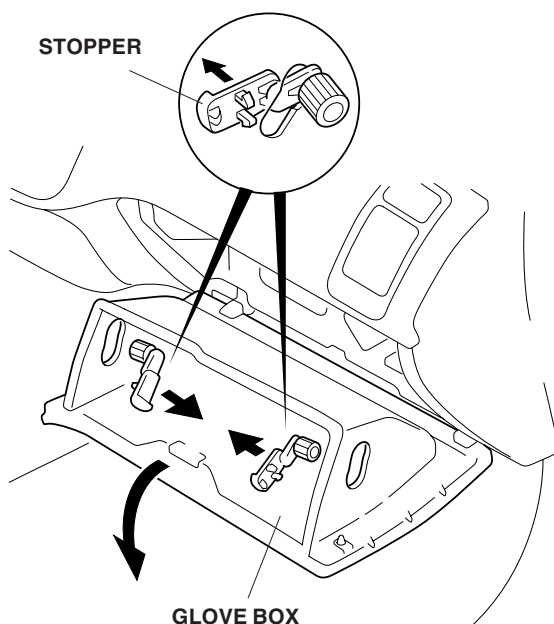

40. Locate the subharness installed in step 28, and route it through the glove box compartment area. Secure the subharness to the vehicle harness with four wire ties and one cushion tape in the areas shown.

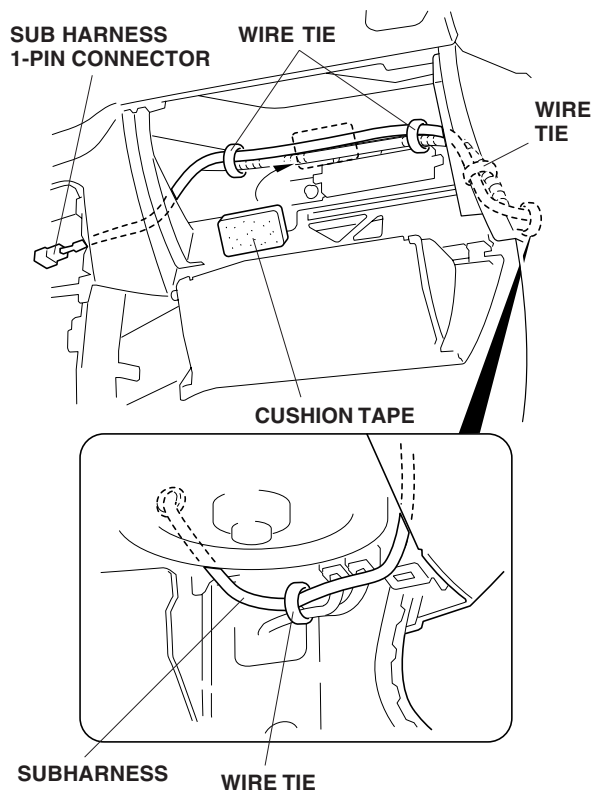

41. Route the switch harness under the dash, and over the steering shaft and the brake pedal position switch harness.

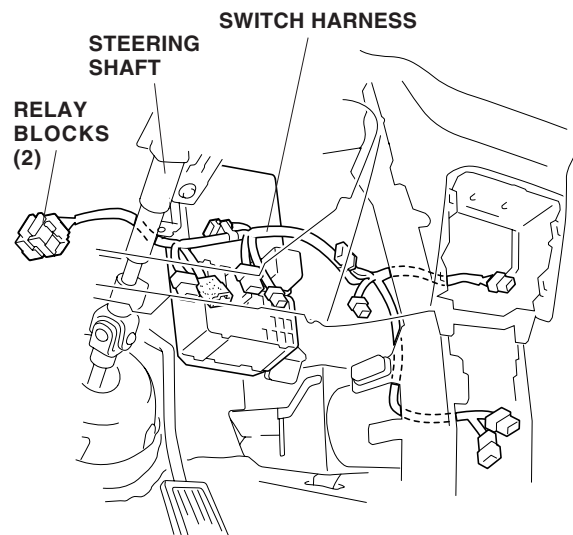

42. Attach the relay bracket to the steering hanger beam using the 6 x 16 mm washer-bolt.

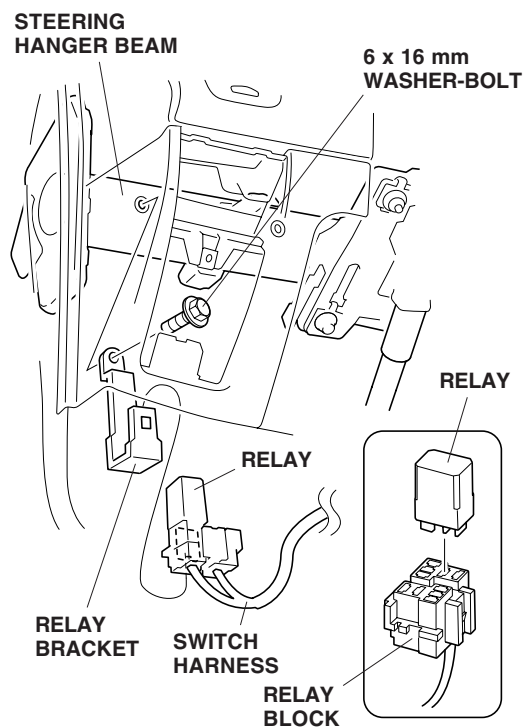

43. Plug the relay into the relay block, then attach the block to the relay bracket.

44. Unplug the vehicle 12-pin connector from the fuse box and connect the 12-pin connectors of the switch harness in between the vehicle 12-pin connector and the fuse box.

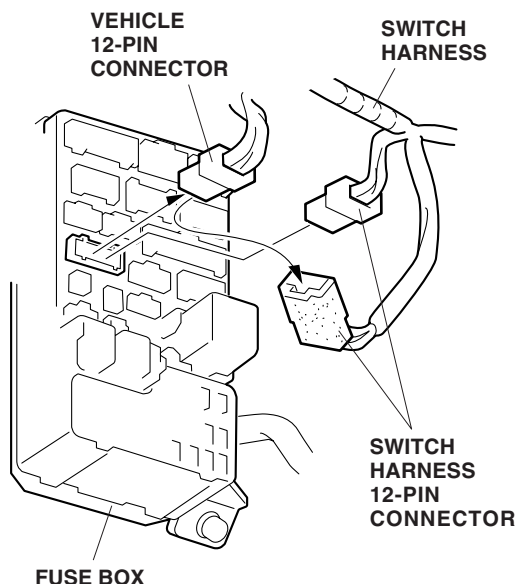

45. Attach the 20A fuse label to the fuse case on the switch harness, and remove the tape to free the switch harness 6-pin connector (A/T only).

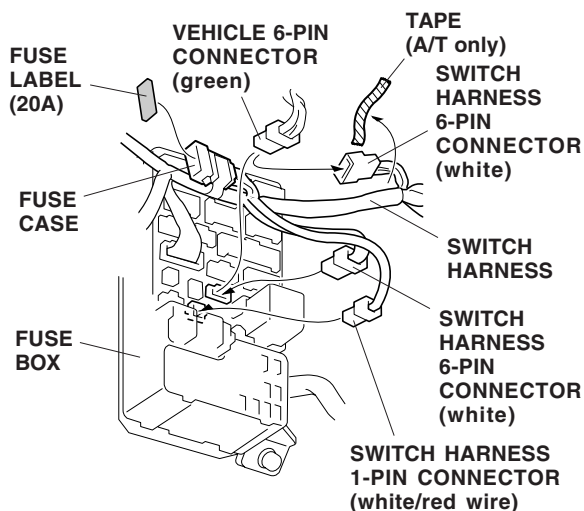

46. On an A/T model, unplug the vehicle 6-pin connector (green) from the fuse box, and plug the white 6-pin connector from the switch harness into the fuse box. Plug the vehicle 6-pin connector (green) into the remaining switch harness 6-pin connector (white).

On a M/T model, the fuse box has no 6-pin connector plugged into the fuse box; plug the switch harness 6-pin connector directly into the fuse box.

47. Plug the switch harness 1-pin connector (white/red wire) into the fuse box in the location shown.

48. Locate the 4-pin and 10-pin connectors near the center console frame, and unplug the connectors. Unclip the 10-pin connector from the 4-pin connector. Plug the switch harness 10-pin connectors in between the vehicle harness 10-pin connectors. Plug in the 4-pin connector, and reattach it to the switch harness 10-pin connector.

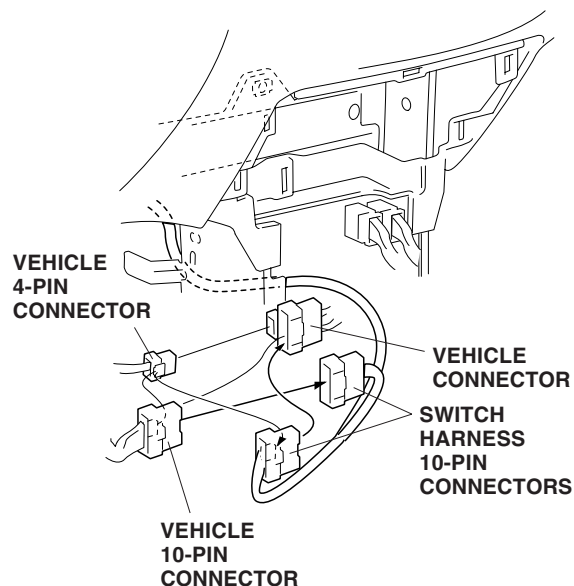

49. Secure the switch harness to the vehicle harness with two wire ties in the areas shown.

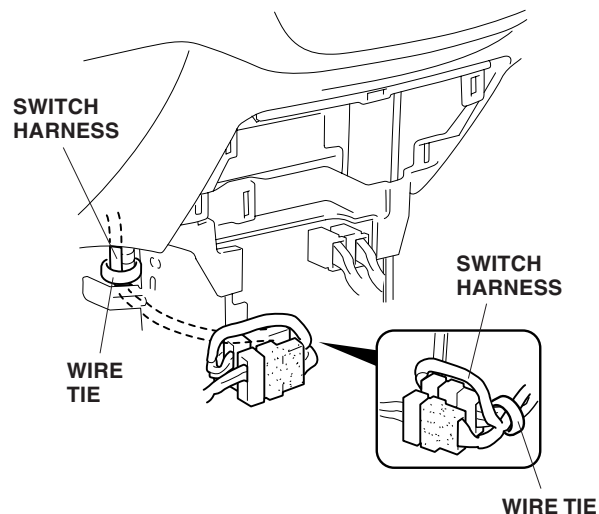

50. Plug the subharness 1-pin connector (routed in step 40) into the switch harness 1-pin connector (blue/red), then wrap one cushion tape around the connectors. Secure the connector to the vehicle harness using one wire tie.

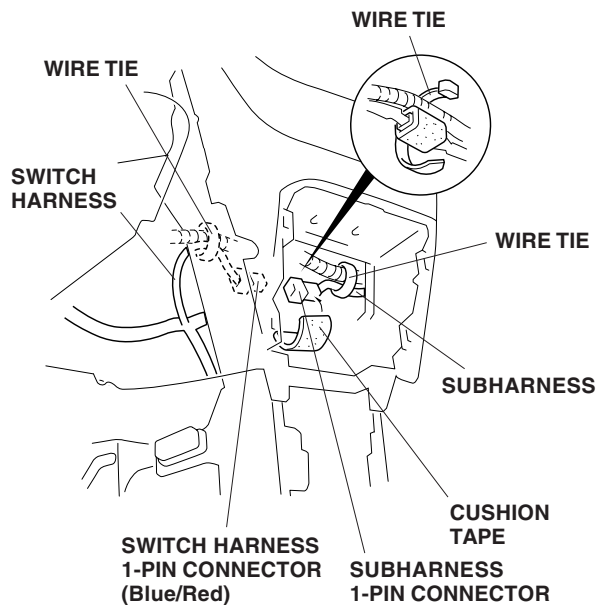

51. Secure the subharness and switch harness to the vehicle harness with two wire ties in the areas shown.
52. Remove and discard the switch cover from the dashboard center lower cover (removed in step 37), then pull the switch harness 5-pin connector out through the hole in the dashboard center lower cover.

Without a Cigarette Lighter and Ashtray

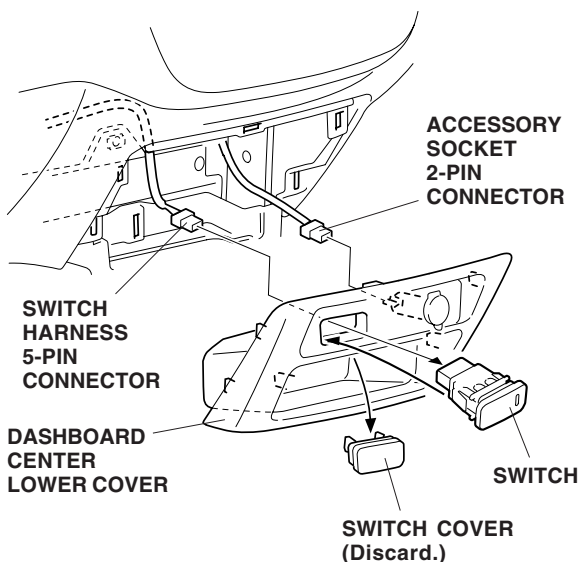

With a Cigarette Lighter and Ashtray

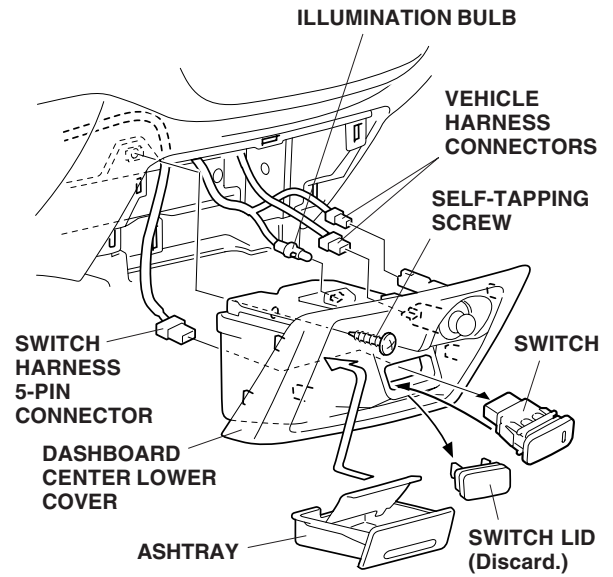

53. Plug the switch harness 5-pin connector into the fog light switch, then install the fog light switch into the lower cover.
54. Reinstall the lower cover.
55. Under the dash, secure the switch harness to the vehicle harness with five additional wire ties in the areas shown.

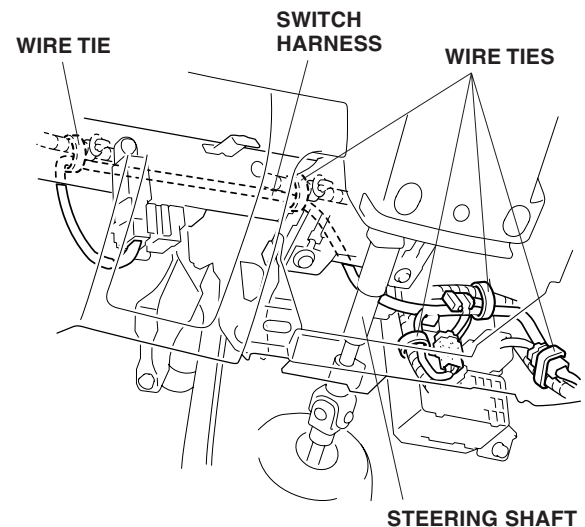

56. Check that all wire harnesses are routed properly (the switch harness doesn't interfere with the steering shaft) and all connectors are plugged in.

57. Reinstall all the removed parts.

58. Reconnect the negative cable to the battery, and reset the radio station presets.

NOTE: Whenever the battery is disconnected, the driver's window AUTO function is disabled.

59. Start the engine. Push down on the driver's window switch until the window is fully open.

60. Pull up on the driver's window switch to close the window completely, then hold the switch for 2 seconds.

61. Lower and raise the driver's window to check operation of the driver's window AUTO function.

62. Do the ECM/PCM idle learn procedure.

- Make sure all electrical items are turned off.
- Start the engine. Hold the engine speed at 3,000 rpm with no load (in Park or Neutral) until the radiator fan comes on.
- Let the engine idle for about 5 minutes with the throttle fully closed and with all electrical items off.

NOTE: If the radiator fan comes on during this step, the time when it is operating must not be included in the 5 minutes.

USE AND CARE

How to Operate Fog Lights

- Turn the light switch to the "on" position (headlights on low beam).
- Press the light switch (indicator is on).

The fog light lenses can cloud when the outside temperature is cold; this is normal and should go away in warm weather.

Fog Light Aiming Adjustment

1. Adjust the fog lights:

- Adjust the aiming according to local laws and regulations.
- To adjust, turn the aiming adjustment screw in or out until the correct aiming is obtained.

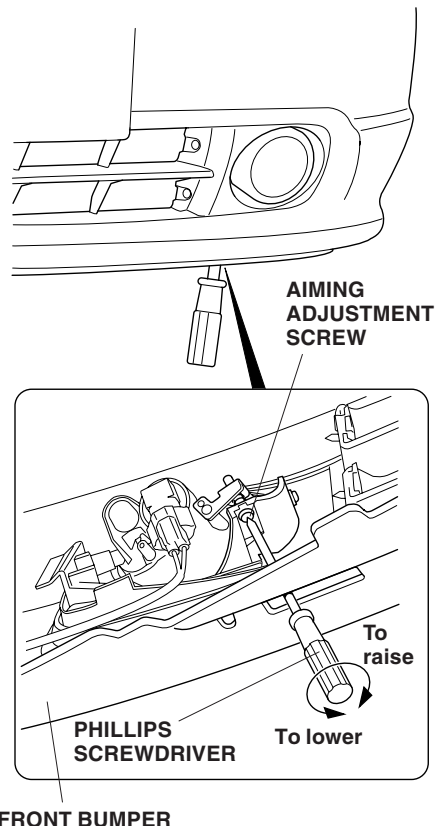

FRONT BUMPER

BULB REPLACEMENT

1. Remove the two self-tapping screws that fasten the fog light, and pull the light out toward you.
2. Unplug the connector from the fog light, then remove the fog light assembly.

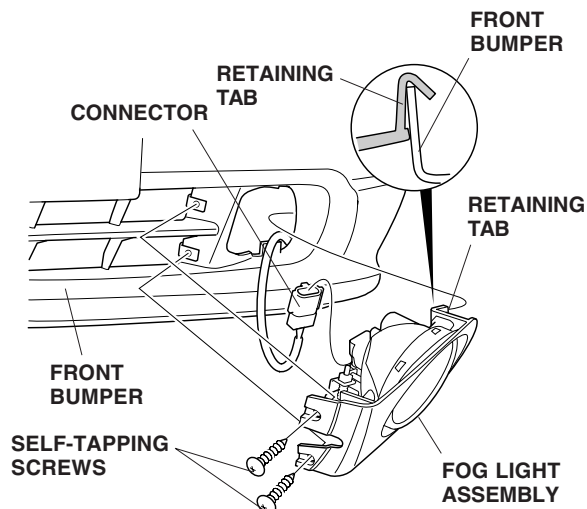

3. Remove the bulb.

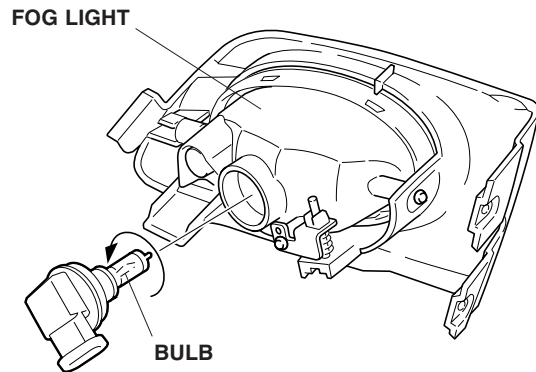

4. Install the new bulb and socket to the fog light.

- Use only a genuine Honda halogen light bulb of specified wattage.

Rating: 12V 55W H11 Halogen Light Bulb
Bulb P/N: 33165-S5A-003

- Do not touch the bulb. Oily or greasy substances on the bulb can shorten its service life due to the heat produced when the bulb is turned on. If the bulb is accidentally touched, wipe it clean with a clean, soft cloth that has been dampened with a denatured alcohol or mild detergent solution.
- Align the tab on the fog light with the cutout in the bulb socket when installing the new bulb. If not aligned, the fog light may not be aimed and annoy oncoming drivers.

5. Reinstall the fog light in the reverse order of removal.

- Check that the wire harnesses are not pinched.
- Be sure to tighten the self-tapping screws securely.

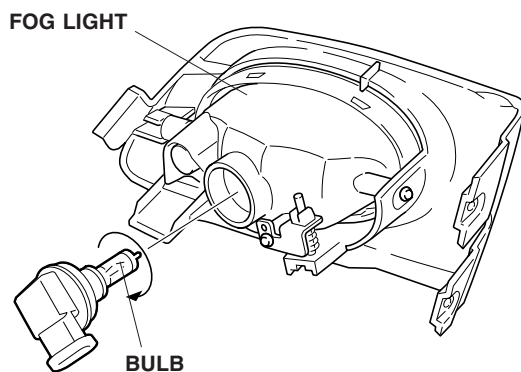

CIRCUIT DIAGRAM

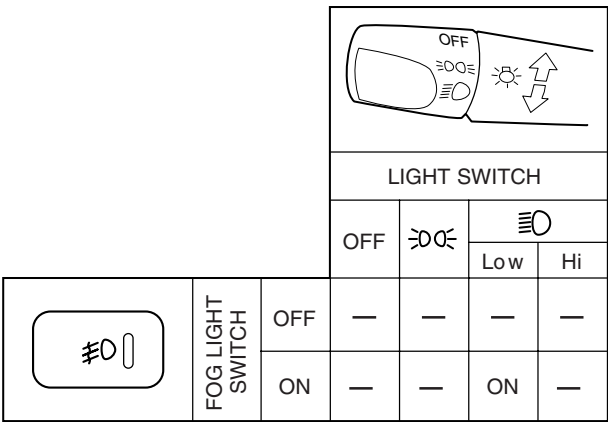
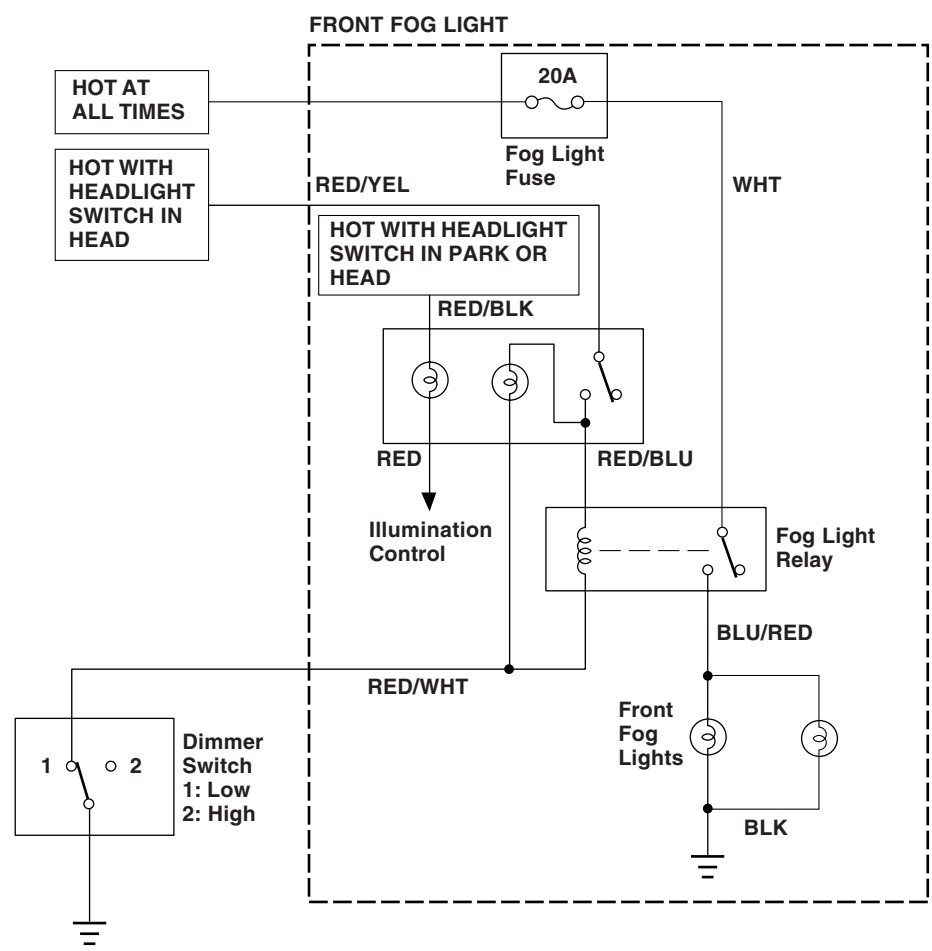

BLK	BLACK	LT BLU	LIGHT BLUE
YEL	YELLOW	BRN	BROWN
BLU	BLUE	ORN	ORANGE
GRN	GREEN	PNK	PINK
RED	RED	GRY	GRAY
WHT	WHITE	LT GRN	LIGHT GREEN